

# The Cypress

**Finished Square Footage: 1,287**

**Starting Rent: TBD per month**

The Cypress presents a well-appointed and inviting home design that blends architectural interest with everyday ease. This one-bedroom, one-and-a-half-bath residence features a generous open kitchen that anchors the main living space, while the upstairs loft offers a flexible area ideal for a home office, lounge, or guest retreat. The primary bedroom is thoughtfully designed with two walk-in closets, providing ample storage without sacrificing style. A covered front porch enhances the home's welcoming presence, and the attached one-car garage adds convenience. With a 627-square-foot basement offering additional storage or future potential, The Cypress is a distinctive floor plan crafted for effortless, modern living.

**Features at a Glance:**

- 1 Bedroom
- 1 1/2 Bathrooms
- Attached 1 car garage
- Covered front porch
- Large, open kitchen
- Primary bedroom features two walk-in closets
- Spacious loft area upstairs
- 627 square foot basement

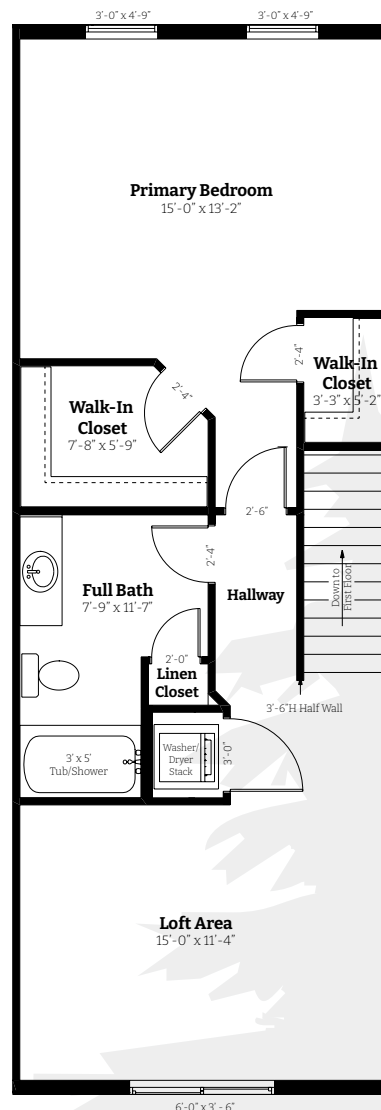
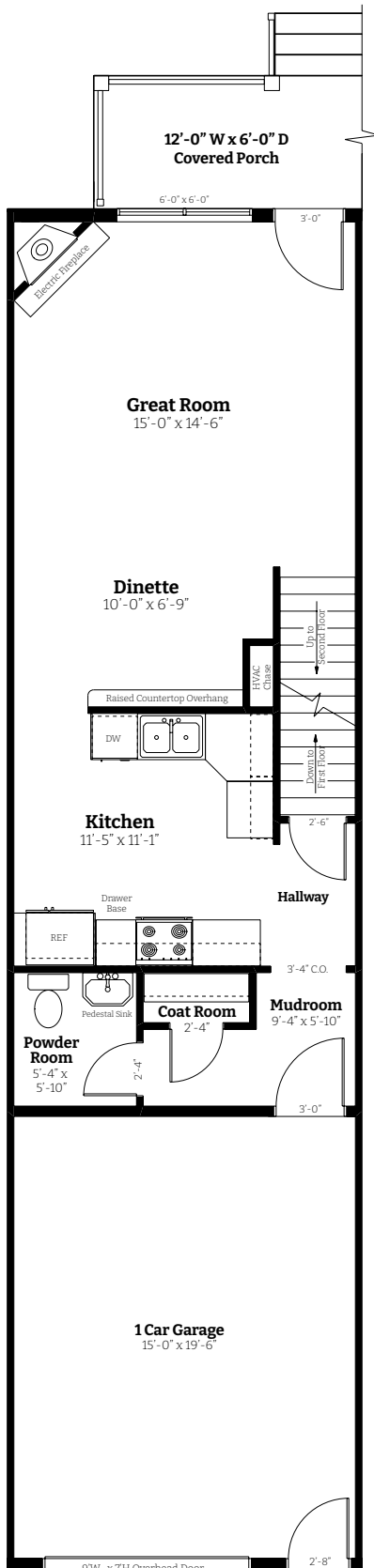

[FieldstoneRidge.com](http://FieldstoneRidge.com)

10 Fieldstone Commons  
Tolland, CT

