

# The Sage

**Finished Square Footage: 1,287**

**Starting Rent: TBD per month**

The Sage offers a thoughtfully designed blend of style and functionality, ideal for those seeking refined living with efficient use of space. This two-bedroom, one-and-a-half-bath townhome features a large, open kitchen that serves as the heart of the home—perfect for everyday living and casual entertaining. The primary bedroom is a true retreat, complete with two walk-in closets for exceptional storage and organization. A covered front porch adds inviting curb appeal, while the attached one-car garage and a 627-square-foot basement provide everyday convenience and flexible space. Designed with comfort and practicality in mind, The Sage delivers elevated living in a beautifully balanced layout.

**Features at a Glance:**

- Two spacious bedrooms
- 1 1/2 bathrooms
- Attached 1 car garage
- Covered front porch
- Large, open kitchen
- Primary bedroom features two walk-in closets
- 627 square foot basement

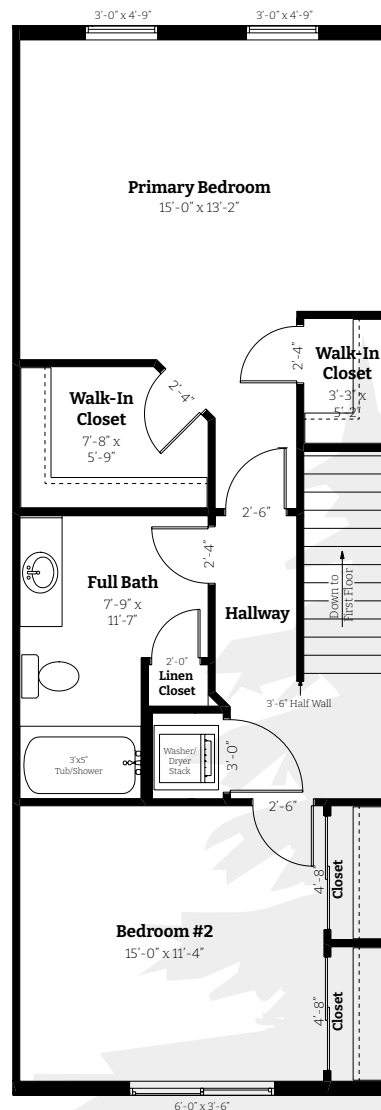
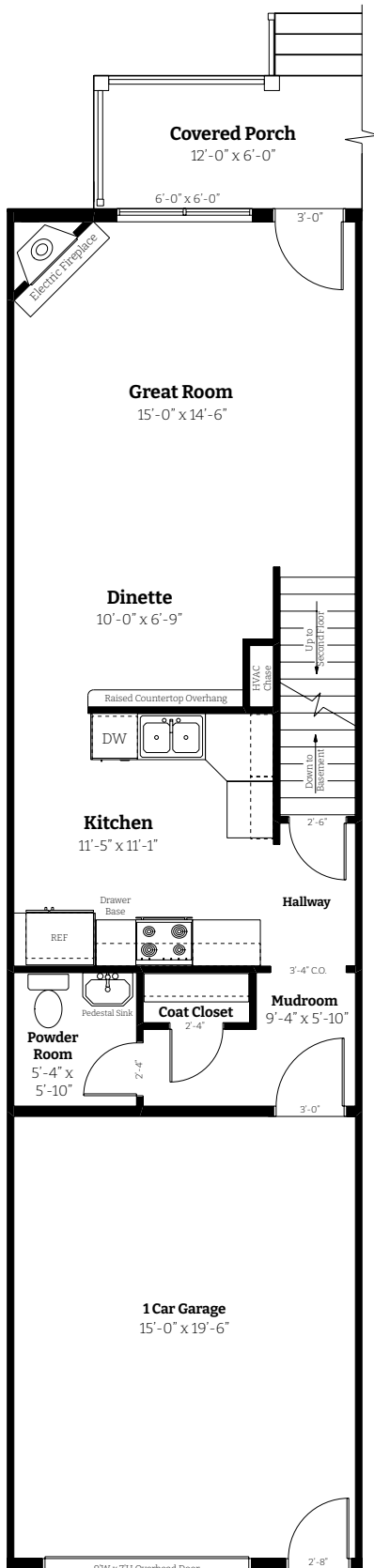

[FieldstoneRidge.com](http://FieldstoneRidge.com)

10 Fieldstone Commons  
Tolland, CT

